

# Volkswagen Passat B8

Rear-view camera assembly manual  
v. 1.0.



**The bundle includes:**

1 pcs	camera built-in VW emblem
1 pcs	drain pipe
1 pcs	Plug&Play wire of 6,5m
1 pcs	Coding manual

1

A

Dismantle the rear trunk lid covering .  
First remove the clamp holding warning triangle.



B

Then loosen the locking tabs which are indicated on the photo.



2

After the covering is loosened remove VW emblem, screw the rear-view camera and connect chips as shown on the photo.

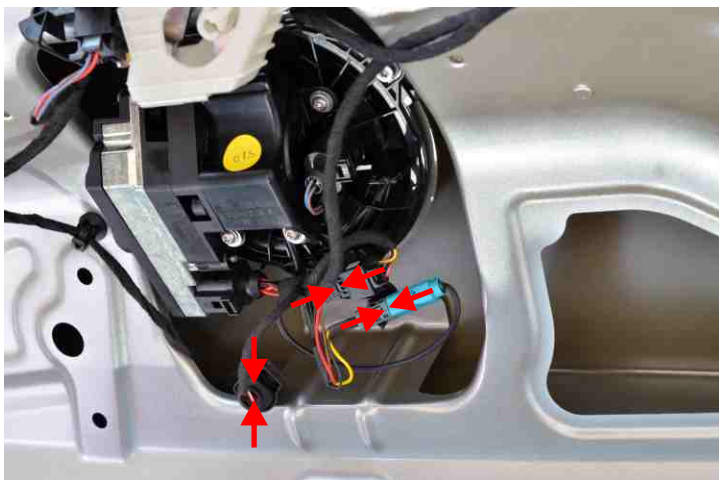

3

Pull the beam through the right side as shown on the photo.



4

Next connect the yellow wire in charge of rear light to the chip of internal lamp PIN number 7. (black and blue wire)



5

A

Dismantle the front and rear right door sill in order to pull the beam through to the storage side.

Rear door sill.



B

Front door.



6

A

Start with dismantling the radio located in the storage compartment on passenger's side. Put the keys releasing locks in the place indicated on the photo and disconnect chips.



**B**

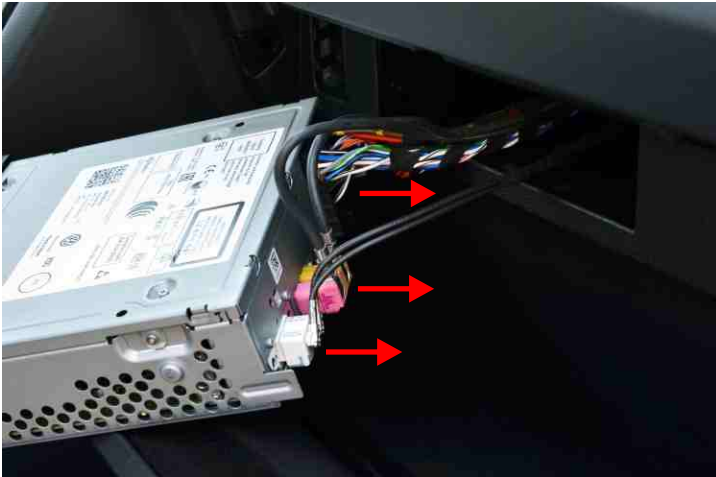

After connecting all wires finish the assembly and assemble everything in reverse order.

**7**

Connect wires for quadlock to the blue chip 8x0035447  
Connect wire no. 1 to 12th socket in the chip.  
Connect wire no. 2 to 6th socket in the chip.

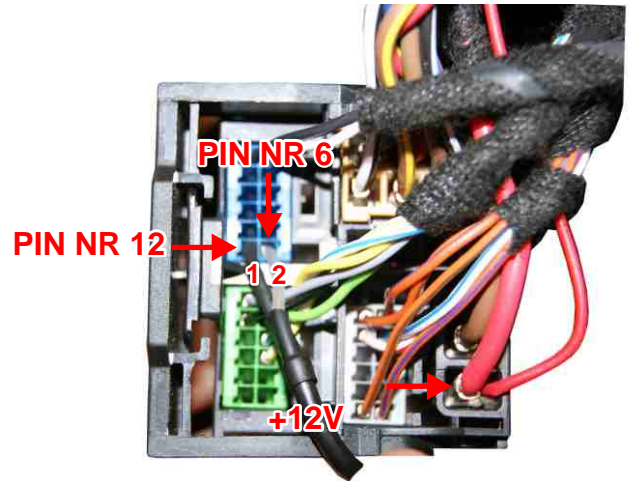

**9**

Coding:  
1. Using diagnostic equipment VCDS open block 5F - *Information Electr.*  
2. Find byte no. 19  
3. Mark byte no. 4

In case the car is equipped with PDC system it will be necessary to code *PDC-10-Park/Steer Assist module.*